

BRLED-10P

Surge Arresters for LED

BRLED-10P-VG
BRLED-10P-NG
BRLED-10P-TT

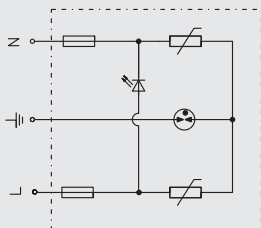
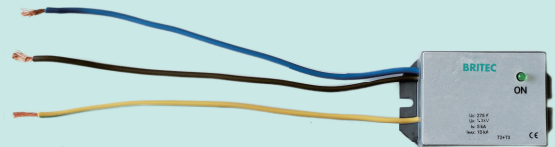

BRLED-10P-VG

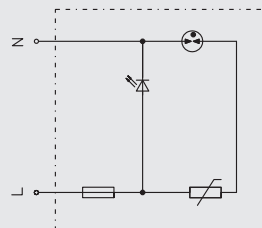

BRLED-10P-NG

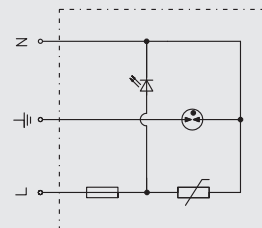

BRLED-10P-TT

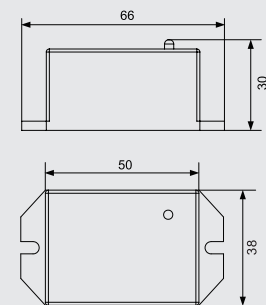

		BRLED-10P-VG	BRLED-10P-NG	BRLED-10P-TT
SPD classification according to EN61643-11		Type 2+Type 3	Type 2+Type 3	Type 2+Type 3
SPD classification according to IEC61643-11		Class II+Class III	Class II+Class III	Class II+Class III
Nominal a.c. voltage	Un	230V	230V	230V
Max. continuous operating a.c. voltage	Uc	275V	275V	275V
Frequency		50-60Hz	50-60Hz	50-60Hz
Nominal discharge current (8/20µs)	In	5kA	5kA	5kA
Max. discharge current (8/20µs)	I _{max}	10kA	10kA	10kA
Combined impulse	Uoc	10kV	10kV	10kV
Voltage protection level	Up	≤1.3kV	≤1.3kV	≤1.3kV
Response time	t _A	≤100ns	≤100ns	≤100ns
Operating temperature range	Tu	-40°C-80°C	-40°C-80°C	-40°C-80°C
Operating state		Green light on: OK, Green light off: Replace		
Enclosure material		Thermoplastic UL94-V0		
Degree of protection		IP 65		
Order Code		B6032	B6033	B6034